

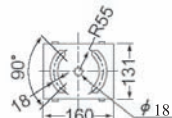

窄角
Narrow

H365SX-ELH

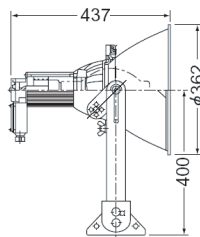
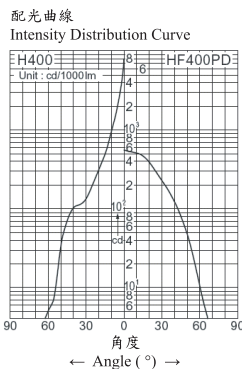

- 適用光源 : 300-400瓦 高強度放電式燈泡
- 燈咀 : E40
- 顏色 : 銀色
- 反光罩 : 灰色
- 燈身 : 鋁
- 燈身 : 壓鑄鋁, 外塗樹脂
- 前置玻璃 : 強化玻璃
- 重量 : 8.6公斤
- 特色 : 防震, 能安裝於可動之裝置上。配置炭過濾器, 反光罩經液體玻璃處理。IP65

- 備註 : 需外置電器箱
- Lamps : 300-400W HID Lamps
- Lamp holder : E40

- Color : Reflector : Silver
- Body : Grey
- Material : Reflector : Aluminium
- Body : Die Cast Aluminium with Polyester Coating
- Front Glass : Tempered Glass
- Weight : 8.6kg.
- Features : Vibration Proof, could be installed on a moving device. With Charcoal Filter, Alglas Reflector, IP65.
- Remarks : Remote Control Gear Needed



寬角
Wide

H365DX-ELH

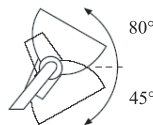
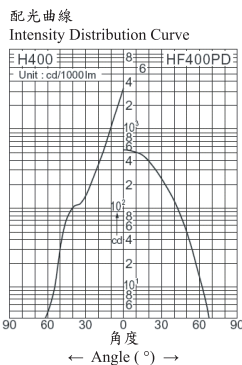

窄角
Narrow

H565SX-ELH

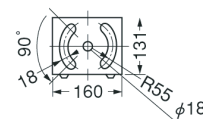
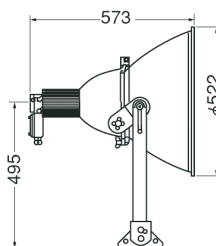
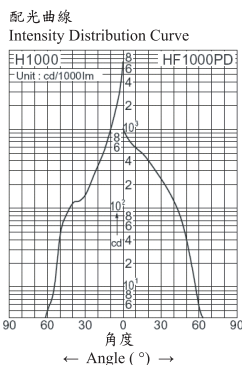

- 適用光源 : 1000瓦 高強度放電式燈泡
- 燈咀 : E40
- 顏色 : 銀色
- 反光罩 : 灰色
- 燈身 : 鋁
- 燈身 : 壓鑄鋁, 外塗樹脂
- 前置玻璃 : 強化玻璃
- 重量 : 14.6公斤
- 特色 : 防震, 能安裝於可動之裝置上。配置炭過濾器, 反光罩經液體玻璃處理。IP65

- 備註 : 需外置電器箱
- Lamps : 1000W HID Lamps
- Lamp holder : E40

- Color : Reflector : Silver
- Body : Grey
- Material : Reflector : Aluminium
- Body : Die Cast Aluminium with Polyester Coating
- Front Glass : Tempered Glass
- Weight : 14.6kg.
- Features : Vibration Proof, could be installed on a moving device. With Charcoal Filter, Alglas Reflector, IP65.
- Remarks : Remote Control Gear Needed



寬角
Wide

H565DX-ELH

